

CATALOGUE



KAIZEN MARKETING SDN. BHD. 201101017582

31A, Jalan Pinggir, Off Jalan Ipoh, 51200 Kuala Lumpur, Malaysia.

Tel: +603-6731 7090 Fax: +603-4041 7090 H/P: 016-3012551 / 012-784 9379

Email: nkaizen@hotmail.com

Website: www.kaizenmarketing.com.my



Content Page

		Page
Under Pressure Vertical Ferrule		01-02
Brass Gate Valve		03
Brass Stop Cock Chrome Stop Cock		04-06
Lockable Valve		06-08
Stainless Steel 304 Fitting		09
P.A Pipe Fitting		10
Tapping tool		11-12
Stainless Steel 304 Repair Clamp		13
Meter Stand		14



VERTICAL FERRULE

TECHNICAL SPECIFICATION:

Specification Ferrule for Saddle 20mm (¾ inch) DN15
 Ferrule for Saddle 25mm (1 inch) DN20

Nominal Pressure PN16

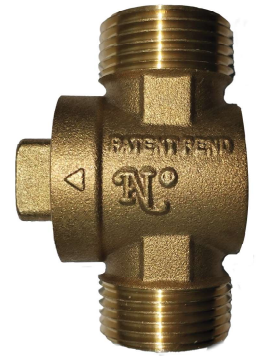

SPECIFICATIONS

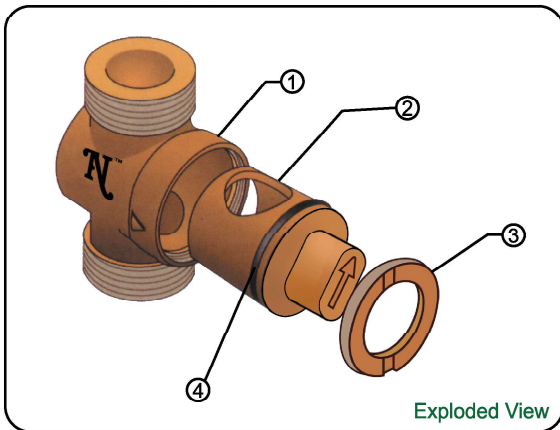

No	Parts	Material
1.	Housing	Standard Brass
2.	Valve	Standard Brass
3.	Cover	Standard Brass
4.	O-Ring	Nitrile Rubber

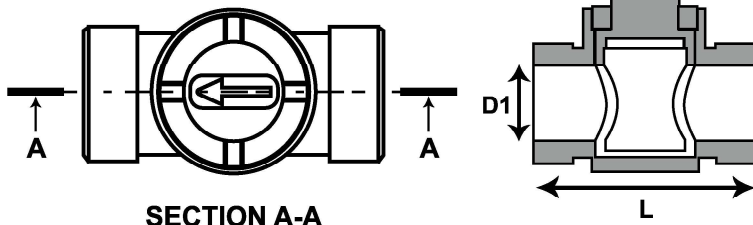

No	Parts	Dimensions
1.	Length, L	68mm
2.	Internal Diameter, D1	15mm

FERRULE DN 15
FOR SADDLE 20mm

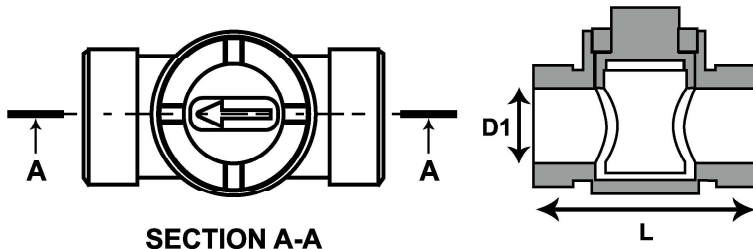

No	Parts	Dimensions
1.	Length, L	78mm
2.	Internal Diameter, D1	22mm

FERRULE DN 20
FOR SADDLE 25mm

*All information in this brochure was correct to the best of our knowledge when originally printed. N ENTERPRISE AND TRADING reserves the right to make changes without notice to product specifications and manufacture processes given the company's policy of continual product improvement.



SWIVEL FERRULE

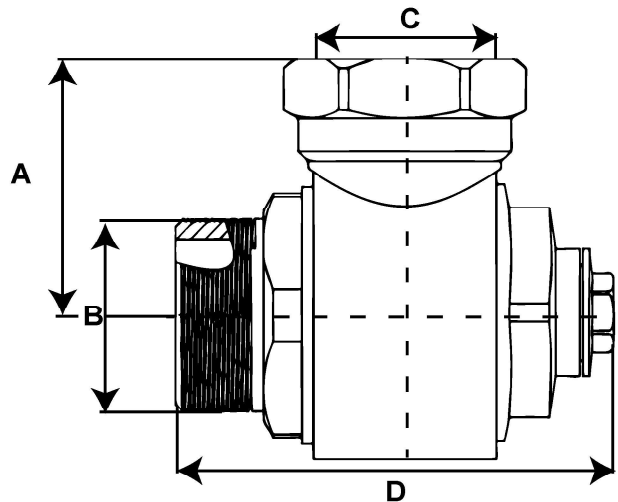

Technical Specification:

Specification	DN 20 (3/4 inch)	DN 25 (1 inch)	DN 50 (2 inch)
Nominal Pressure	PN16		

SIZE	A	B	C	D
3/4"	42.5	PT 3/4"	PS 3/4"	88.0
1"	48	PT 1"	PS 1"	95
2"	80	PT 2"	PS 2"	137

*All measurement in millimeters(mm)



SPAN

SPAN[®] BRASS GATE VALVE

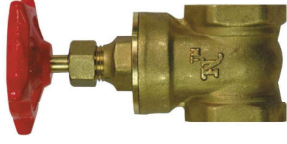

CHARACTERISTICS IN CONSTRUCTION AND APPLICATION

- The stem is connected with flashboard through left-hand trapezoidal thread.
- The PTFE packing has contact sealing with the valve stems in order to prevent damages to the valve stems.
- Sealing style: metal, metal-palistic.
- To be used in commercial and residential general service applications.
- Hard seal is unsuitable to be mounted at the terminal.

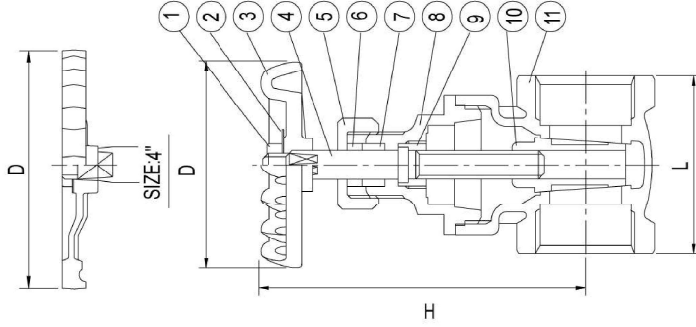

No	Parts	Material
1.	Wheel Nut	Steel
2.	Name Plate	Aluminum
3.	Hand Wheel	Cast Iron
4.	Stem	Brass
5.	Packing Nut	Brass / Cast Brass
6.	Gland	Brass
7.	Gland Packing	Graphite
8.	Bonnet	Cast Brass
9.	Lock Nut	Brass
10.	Disc	Cast Brass
11.	Body	Cast Brass

Nominal Size	Dimension(mm)		
	L	H	D
3/4"	47	85.5	55
1"	50	96	65
1 1/4"	66	118	71
1 1/2"	65	128	71
2"	71.5	152	91
2 1/2"	89	186	105
3"	101	222/220	130/112
4"	116	249/258	172/132

BRASS GATE VALVE

SPAN



SPAN



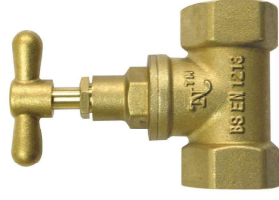

- CHARACTERISTICS IN CONSTRUCTION AND APPLICATION**
- The stem is connected with flashboard through left-hand trapezoidal thread.
 - The PTFE packing has contact sealing with the valve stems in order to prevent damages to the valve stems.
 - Sealing style: metal, metal-pallistic.
 - To be used in commercial and residential general service applications.
 - Hard seal is unsuitable to be mounted at the terminal.

TN[®] BRASS STOP COCK MAINTENANCE FREE !!!

- Corrosion Free
- Maintenance Free
- full brass headwork
- Safe for consumption
- No harmful substances

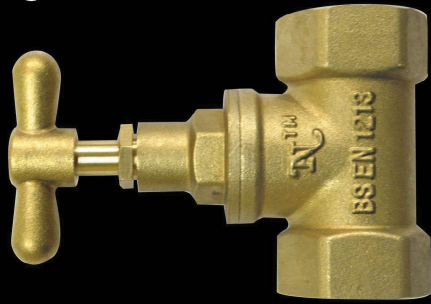

full brass headwork

full brass headwork that maintenance free, unlike headwork that use rubber which will harden and cause of leakage.

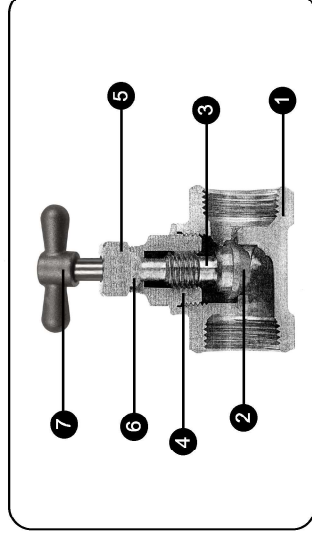
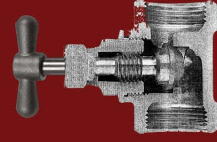

No	Parts	Material
1	Body	Standard Brass
2	Flap	Standard Brass
3	Stem	Standard Brass
4	Bonnet	Standard Brass
5	Packing nut	Standard Brass
6	Packing	Standard Brass
7	Handle	Standard Brass

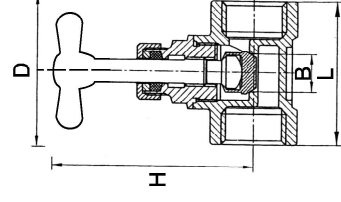

Nominal Size	Dimension(mm)		
	L	H	D B
1/2"	52	68	47 16
3/4"	60	81	47 22
1"	72	98	60 26

~~CHROME STOCK COCK~~
~~CHROME STOCK COCK~~

TV[®]

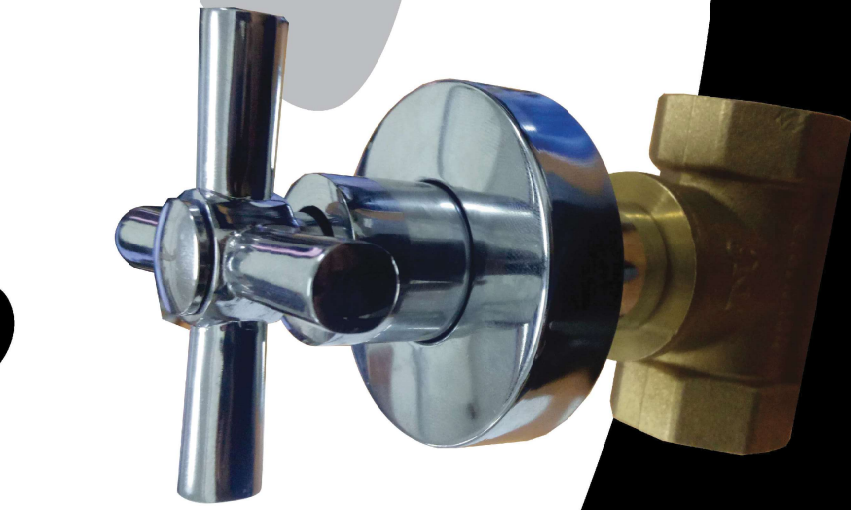

CONCEAL STOP COCK EXTENTION

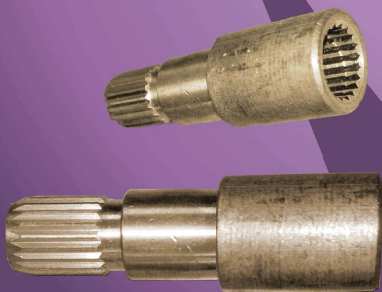

COMPATIBLE
With Most
Conceal Stop Cock
In The Market

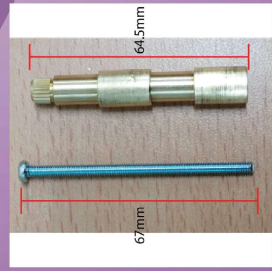
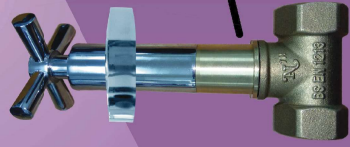
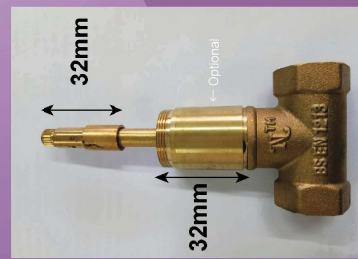

N[®] LOCKABLE VALVE

TECHNICAL SPECIFICATION:

SPECIFICATION

DN20 (3/4 inch)

Nominal Pressure

PN16

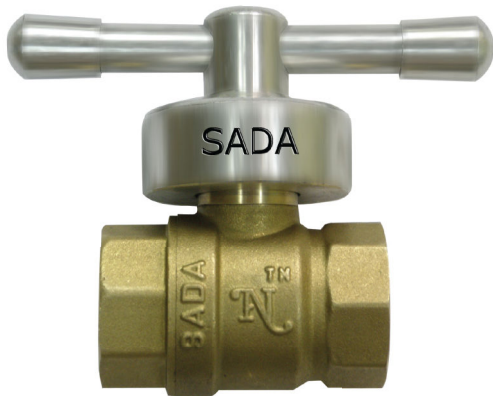

DIMENSION

A	58 mm
B	18 mm
C	3/4 inch
D	32 mm

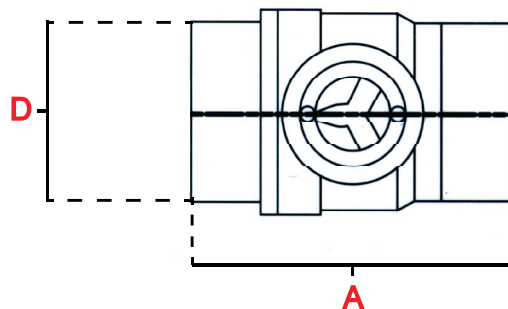
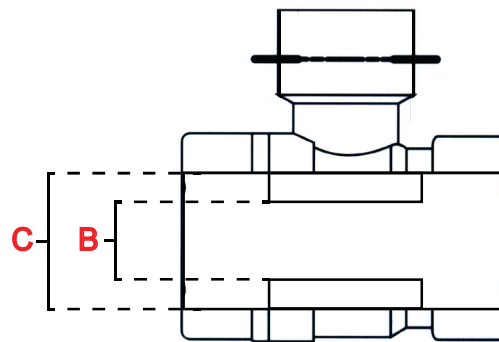

Description

- Magnetic Lockable Valve is a valve designed to be located at the water meter stand to shut off / control water sources from the water mains to consumer connection.
- Magnetic Lockable Valve is a tamper proof valve which has a unique magnetic cap to control the water flow through the meter stand to consumer connection.
- Magnetic Lockable Valve has a high pressure capability, tested up to 16 bars.

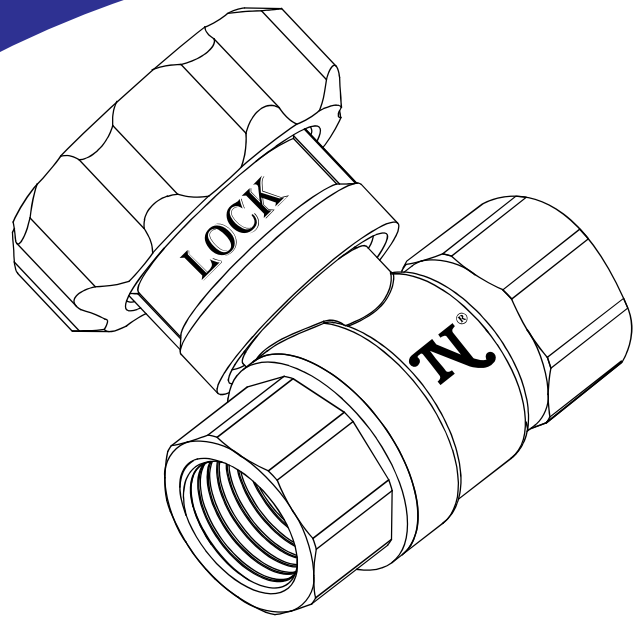

LOCKABLE VALVE (II)



Technical Specification:

Specification	DN 15 (1/2 inch)	DN 20 (3/4 inch)
Nominal Pressure	PN16	PN16
Dimension		
A	1/2"	3/4"
B	Ø 14.5	Ø 19
C	48.5	55.3
D	26	32



*All dimensions are in "mm" unless otherwise stated

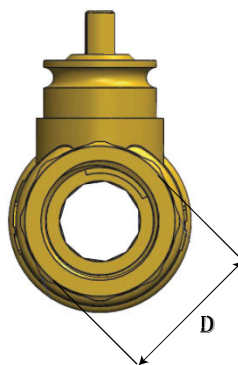
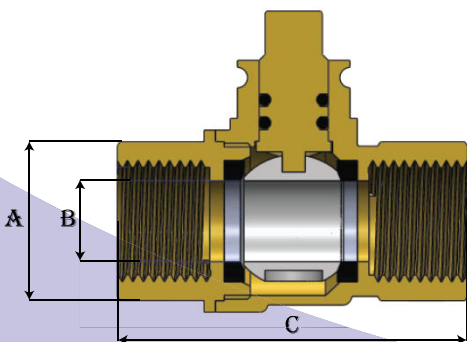

LOCKABLE VALVE (III)

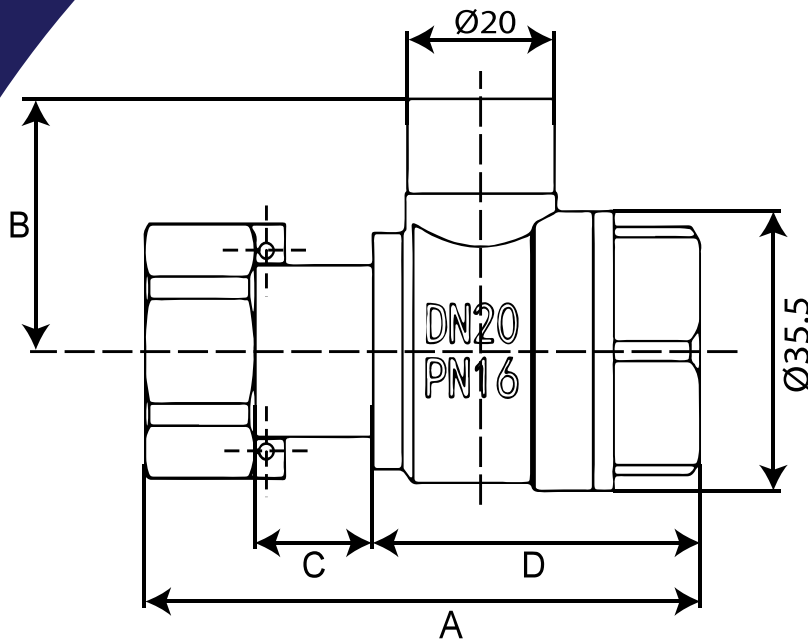

Technical Specification:

Specification	DN 20 (3/4 inch)
Nominal Pressure	PN16

SIZE	A	B	C	D
3/4"	76.5	32	16	46

*All measurement in milimeters(mm)

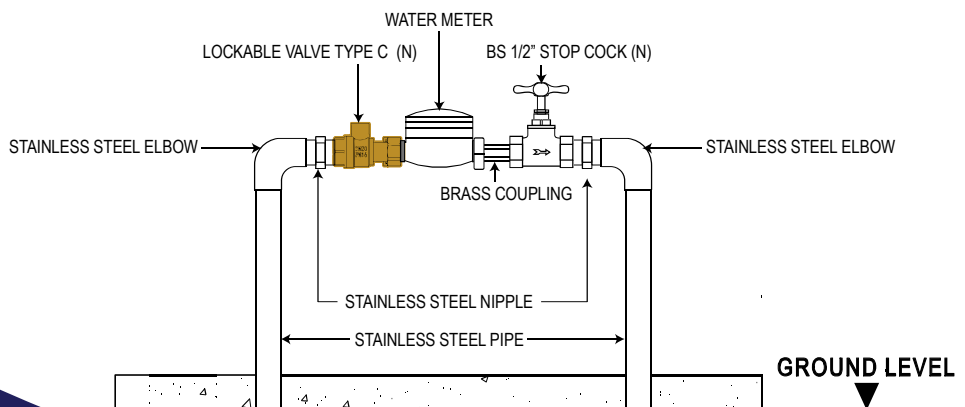

SPAN

Features

- Self healing properties of stainless steel fittings help reduce the penetration of rust/corrosion and eliminate damage to the fitting.
- Stainless steel fittings retain their strength in extreme heat and extreme cold conditions.
- Fitting surface is easy to maintain and keep clean.
- Easy cleaning capabilities make these fittings perfect for food processing and other hygienic areas where wash downs are common.
- Superior strength and durability greatly reduce replacement of fittings - this will lower your total cost of ownership and increase your return on investment.
- Stainless steel fittings do not require harsh environment-damaging cleaners to keep them looking like new.



Trade Sizes 1/2" to 4"
Fittings Material 304 stainless steel
Nominal Pressure 150lb / 2.0 MPa

NO.1 90 ELBOW

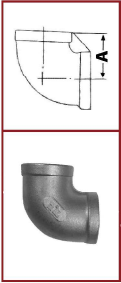

NO.4 45 ELBOW

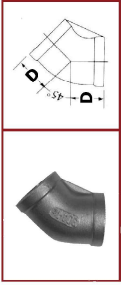

NO.7 HEXAGON NIPPLE

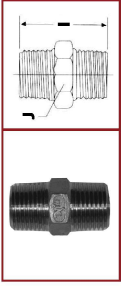

NO.2 TEE



NO.5 CONICAL UNION

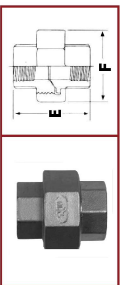

NO.8 ROUND CAP

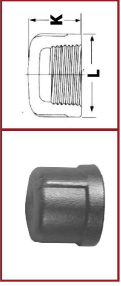

NO.3 STREET ELBOW

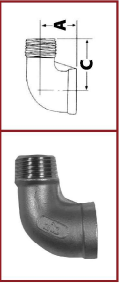

NO.6 SQUARE PLUG

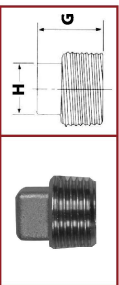

NO.9 EQUAL SOCKET



NO.10 RED . ELBOW

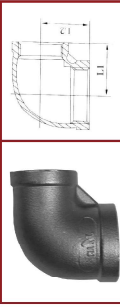

NO.11 RED . TEE

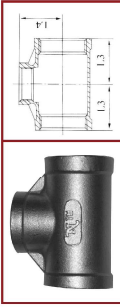

NO.12 RED . SOCKET

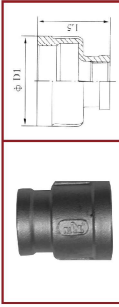

NO.13 RED . HEX .NIPPLE

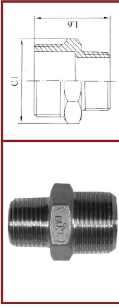

NO.14 HEX . BUSHING

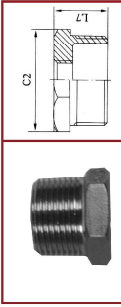

NO.15 SOCKET M&F



SIZE1	SIZE2	L1	L2	L3	L4	L5	D1	L6	C1	L7	C2
1/2	1/8					34	28	38	23	21	24
	1/4			24	24	34	28	38	23	21	24
	3/8			24	26	34	28	39	23	21	24
	1/2					38	33	40.5	30	24	30
	3/4					42	36	44	36	27	35
	1					48	41	49	41	36	45
	1 1/2					54	44	54	44	36	45
	2					60	47	60	47	36	45
	2 1/2					66	50	66	50	36	45
	3					72	53	72	53	36	45
	3 1/2					78	56	78	56	36	45
	4					84	59	84	59	36	45
	4 1/2					90	62	90	62	36	45
	5					96	65	96	65	36	45
	5 1/2					102	68	102	68	36	45
	6					108	71	108	71	36	45
	6 1/2					114	74	114	74	36	45
	7					120	77	120	77	36	45
	7 1/2					126	80	126	80	36	45
	8					132	83	132	83	36	45
	8 1/2					138	86	138	86	36	45
	9					144	89	144	89	36	45
	9 1/2					150	92	150	92	36	45
	10					156	95	156	95	36	45
	10 1/2					162	98	162	98	36	45
	11					168	101	168	101	36	45
	11 1/2					174	104	174	104	36	45
	12					180	107	180	107	36	45
	12 1/2					186	110	186	110	36	45
	13					192	113	192	113	36	45
	13 1/2					198	116	198	116	36	45
	14					204	119	204	119	36	45
	14 1/2					210	122	210	122	36	45
	15					216	125	216	125	36	45
	15 1/2					222	128	222	128	36	45
	16					228	131	228	131	36	45
	16 1/2					234	134	234	134	36	45
	17					240	137	240	137	36	45
	17 1/2					246	140	246	140	36	45
	18					252	143	252	143	36	45
	18 1/2					258	146	258	146	36	45
	19					264	149	264	149	36	45
	19 1/2					270	152	270	152	36	45
	20					276	155	276	155	36	45
	20 1/2					282	158	282	158	36	45
	21					288	161	288	161	36	45
	21 1/2					294	164	294	164	36	45
	22					300	167	300	167	36	45
	22 1/2					306	170	306	170	36	45
	23					312	173	312	173	36	45
	23 1/2					318	176	318	176	36	45
	24					324	179	324	179	36	45
	24 1/2					330	182	330	182	36	45
	25					336	185	336	185	36	45
	25 1/2					342	188	342	188	36	45
	26					348	191	348	191	36	45
	26 1/2					354	194	354	194	36	45
	27					360	197	360	197	36	45
	27 1/2					366	200	366	200	36	45
	28					372	203	372	203	36	45
	28 1/2					378	206	378	206	36	45
	29					384	209	384	209	36	45
	29 1/2					390	212	390	212	36	45
	30					396	215	396	215	36	45
	30 1/2					402	218	402	218	36	45
	31					408	221	408	221	36	45
	31 1/2					414	224	414	224	36	45
	32					420	227	420	227	36	45
	32 1/2					426	230	426	230	36	45
	33					432	233	432	233	36	45
	33 1/2					438	236	438	236	36	45
	34					444	239	444	239	36	45
	34 1/2					450	242	450	242	36	45
	35					456	245	456	245	36	45
	35 1/2					462	248	462	248	36	45
	36					468	251	468	251	36	45
	36 1/2					474	254	474	254	36	45
	37					480	257	480	257	36	45
	37 1/2					486	260	486	260	36	45
	38					492	263	492	263	36	45
	38 1/2					498	266	498	266	36	45
	39					504	269	504	269	36	45
	39 1/2					510	272	510	272	36	45
	40					516	275	516	275	36	45
	40 1/2					522	278	522	278	36	45
	41					528	281	528	281	36	45
	41 1/2					534	284	534	284	36	45
	42					540	287	540	287	36	45
	42 1/2					546	290	546	290	36	45
	43					552	293	552	293	36	45
	43 1/2					558	296	558	296	36	45
	44					564	299	564	299	36	45
	44 1/2					570	302	570	302	36	45
	45					576	305	576	305	36	45
	45 1/2					582	308	582	308	36	45
	46					588	311	588	311	36	45
	46 1/2					594	314	594	314	36	45
	47					600	317	600	317	36	45
	47 1/2					606	320	606	320	36	45
	48					612	323	612	323	36	45
	48 1/2					618	326	618	326	36	45
	49					624	329	624	329	36	45
	49 1/2					630	332	630	332	36	45
	50					636	335	636	335	36	45
	50 1/2					642	338	642	338	36	45
	51					648	341	648	341	36	45
	51 1/2					654	344	654	344	36	45
	52					660	347	660	347	36	45
	52 1/2					666	350	666	350	36	45
	53					672	353	672	353	36	45



Polyethylene Aluminium Composite Pipe Brass Fitting



Male Socket

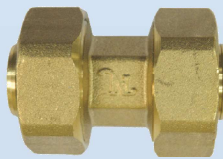

Socket

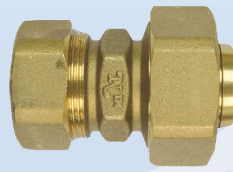

Reducing Socket



Female Socket



Male Elbow



Elbow



Tee



Female Elbow



SPAN

UNDER PRESSURE MECHANICAL TAPPING TOOL

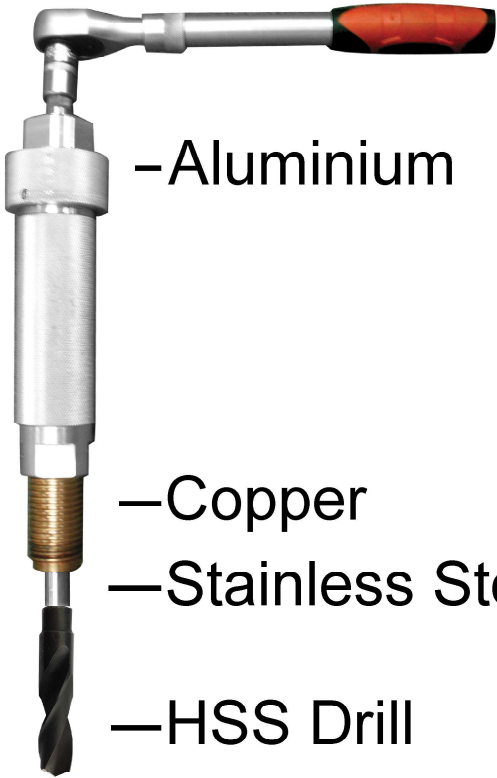

-Aluminium

-Copper

-Stainless Steel

-HSS Drill

America
Standard

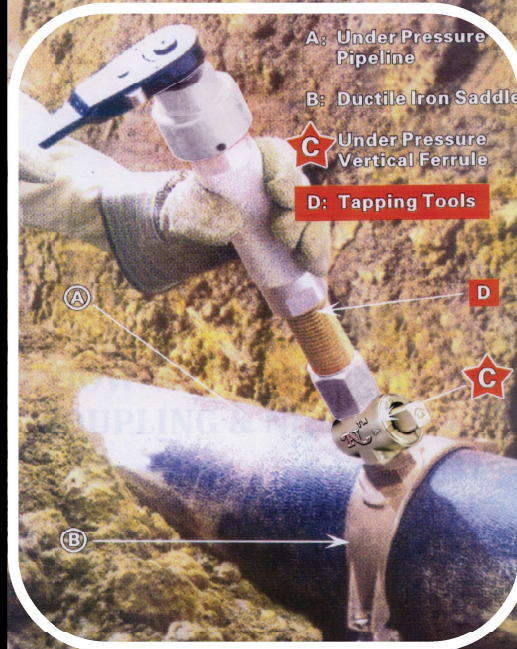
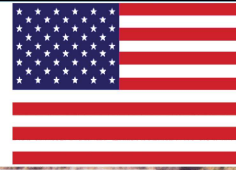

FULLSET

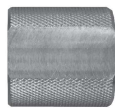

Reducer

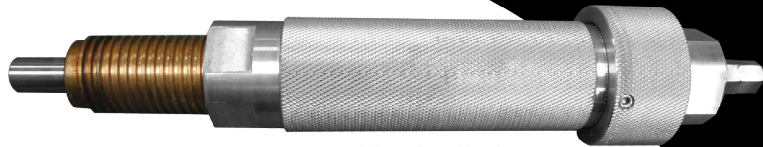

Tapping Body



Spanner



Ratchet

FOC



High Speed Steel Drill
For M.S / D.I Pipe



SS316 Drill Bit For
UPVC / AC / HDPE

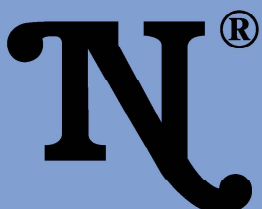

KAIZEN MARKETING SDN. BHD. 201101017582

31A, Jalan Pinggir, Off Jalan Ipoh, 51200 Kuala Lumpur, Malaysia.

Tel: +603-6731 7090 Fax: +603-4041 7090 H/P: 016-3012551 / 012-784 9379

Email: nkaizen@hotmail.com

Website: www.kaizenmarketing.com.my

PERINGATAN PRECAUTION

Sila guna dua jari sahaja bila memasing badan tapping tool semasa penggerudian. Bit gerudi mungkin akan pecah akibat tekanan tinggi

Please use only two finger to turn the tapping tool body when drilling. Drill bit might broken cause of high pressure

Memusing dengan berhati-hati, ikut arah Jam

Turn gently in clock wise



KAIZEN MARKETING SDN. BHD. 201101017582
 31A, Jalan Pinggir, Off Jalan Ipoh, 51200 Kuala Lumpur, Malaysia.
 Tel: +603-6731 7090 Fax: +603-4041 7090 H/P: 016-3012551 / 012-784 9379
 Email: nkaizen@hotmail.com
 Website: www.kaizenmarketing.com.my



INSTRUCTION

2 Install the tapping tool
 Install the tapping tool and connect to the reducer.

4

Drilling
 Turn the drill handle until the drillsaw reach the pipe surface. Start using ratchet to drill in clock wise direction. After drilling, reverse the handle to raise. [Electric drill can also be used to do the drilling.]

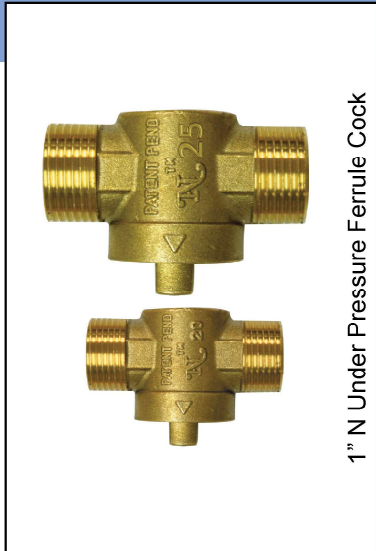

1" N Under Pressure Ferrule Cock

1

Mounting the saddle
 Fasten the saddle with bolts and nuts. Fit the 'N' Ferrule onto the saddle.

3

Opening The 'N' Ferrule
 Make sure the 'N' ferrule is correctly open, after setting the drill.

5

Completion
 After raising the drill, close the 'N' ferrule before disconnect from the reducer.

Badan Mata Gerudi Pembuka Lubang



sepana 105mm



Ratchet



SS304 Fitting



1/2"(14mm) 3/4"(18mm) 2"(40mm)



Mata Gerudi

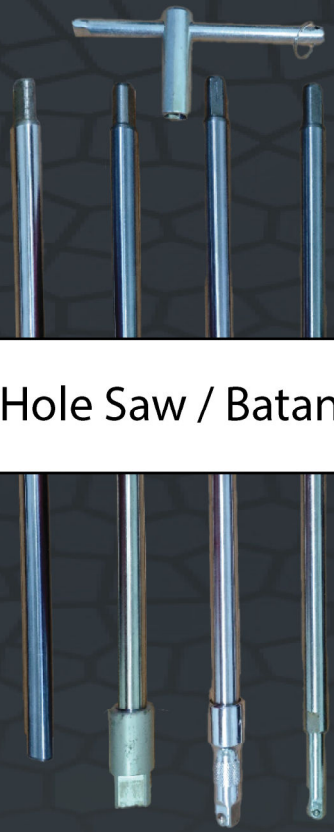

Batang Hole Saw / Batang Penutup

N[®] Tapping Tool **Black** SERIES 3/4", 1", 2"

Ball Valve

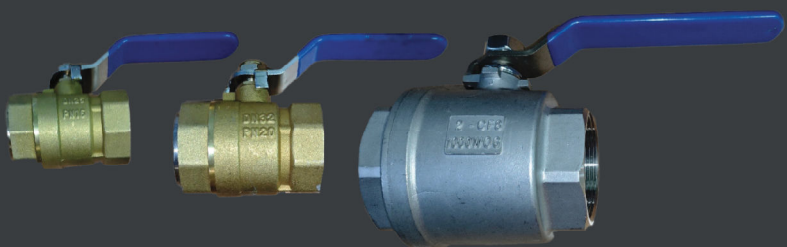

Swivel ferrule



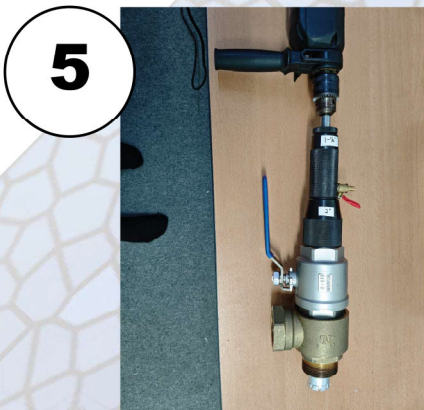
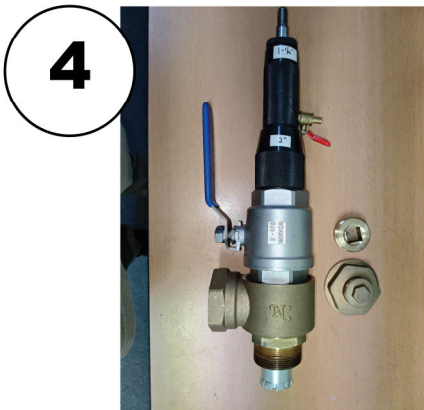
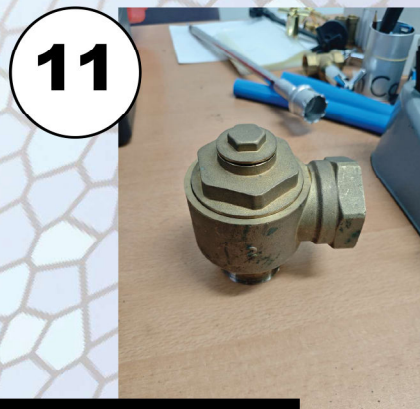
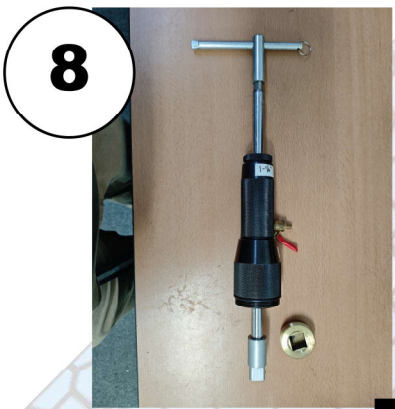
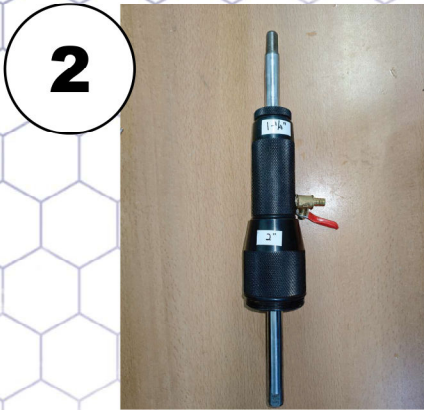
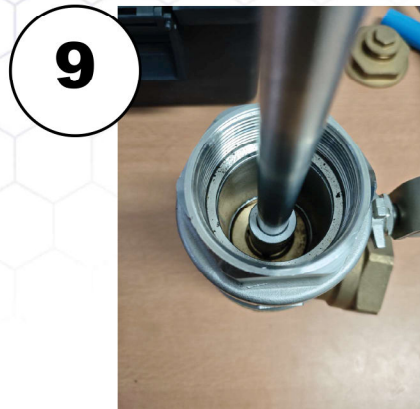

T[®] Tapping Tool Black

STAINLESS STEEL REPAIR CLAMP FOR UNDER PRESSURE PIPE REPAIR



Installation Process

Single Band

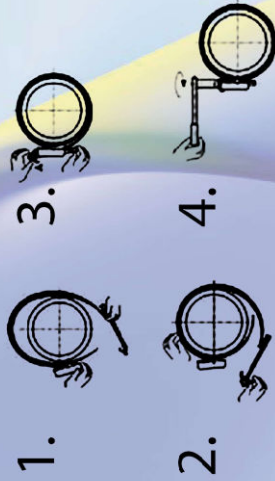

Double Band

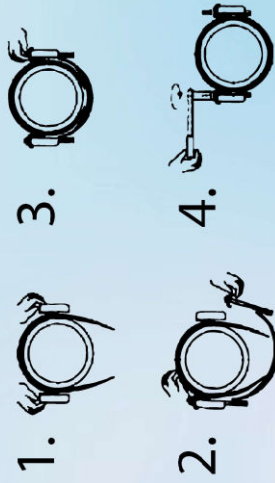

Description of the Material

No.	Component	Material
1	Bolt	Stainless Steel 304
2	Lug Plate	Stainless Steel 304
3	Counter Plate	Stainless Steel 304
4	Washer	Stainless Steel 304
5	Nut	Stainless Steel 304
6	Gasket	EPDM
7	Welding Plate	Stainless Steel 304
8	Band	Stainless Steel 304

Single Band

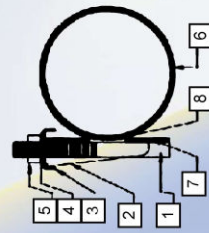

Double Band

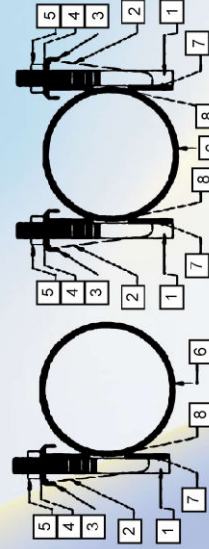

Specifications & Parameters Chart

Size	Working Range (mm)	Length (mm)	Band	No. of Bolts	Dia. of Bolts x Length (mm)	Working Pressure (PN)
DN100	105-115	200	Single	2	M16 X 165	16
	114-122	200	Single	2	M16 X 165	16
DN150	155-165	200	Single	2	M16 X 165	16
	155-165	400	Single	4	M16 X 165	16
	168-178	200	Single	2	M16 X 165	16
DN200	175-185	300	Single	3	M16 X 165	16
	219-233	200	Single	2	M16 X 165	16
	220-230	300	Single	3	M16 X 165	16
DN250	273-286	200	Single	2	M16 X 165	16
	280-291	400	Single	4	M16 X 165	16
DN300	312-322	400	Single	4	M16 X 165	16
	323-345	250	Double	6	M16 X 165	16
DN400	390-410	400	Double	8	M16 X 165	12
DN500	490-510	400	Double	8	M16 X 165	12

TN[®]



STAINLESS STEEL REPAIR CLAMP FOR UNDER PRESSURE PIPE REPAIR

- Brief**
- For All Kinds Of Pipe Materials (Asbestos Cement, Mild Steel, Ductile Iron, GRP & Plastic Pipes)
 - Working Pressure PN16
 - Temperature From -10°C to + 70°C
 - Seal : EPDM

- Standards**
- AS 4181 : 2013

- Features**
- Size Range From DN80 - DN350
 - Both Underground And Above Ground Applications
 - Quick And Under Pressure Repairing
 - Suitable For Potable Water And Sewage
 - Repairing Longitudinal Cracks, Holes & Pitting (Pin Holes)
 - Suitable For Plastic Pipes Materials \geq PN10
 - If The Damage Is \geq 100mm, It Is Only Suitable For Emergency Repairs

Meter Stand



1/2", 3/4", 1"

as per order

ITEM NO	DESCRIPTION	SIZE(MM)	QTY
1	STAINLESS STEEL PIPE	20 x 730	2
2	STAINLESS STEEL ELBOW 90°	20	4
3	STAINLESS STEEL NIPPLE	20	2
4	STAINLESS STEEL BUSH	20 x 15	2
5	LOCKABLE VALVE	20	1
6	STOP COCK	20	1

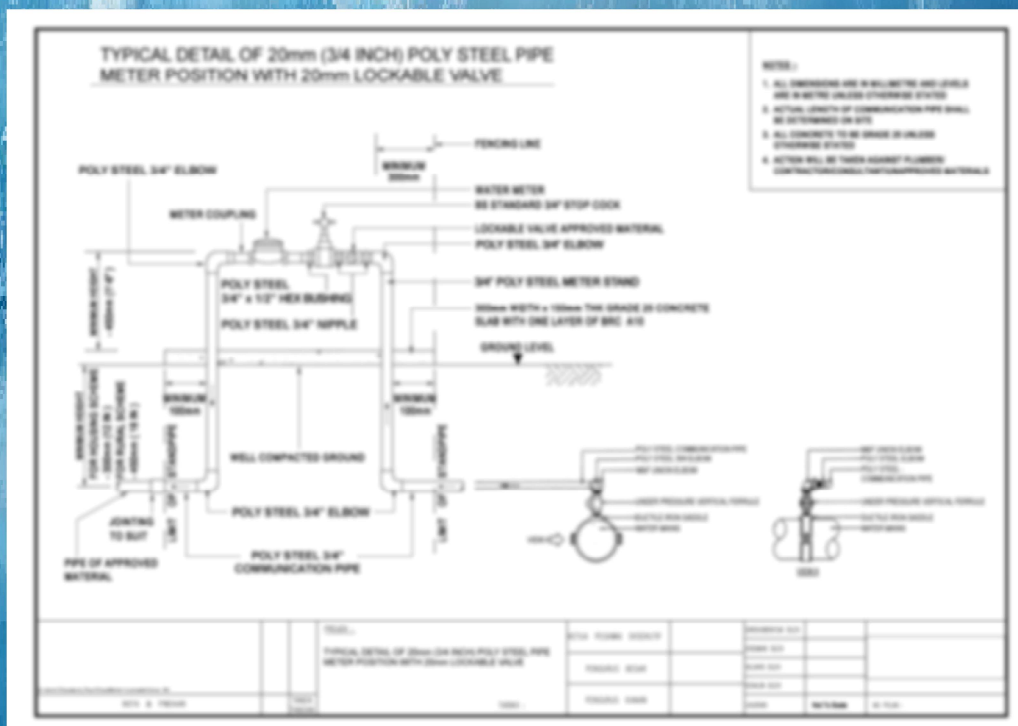
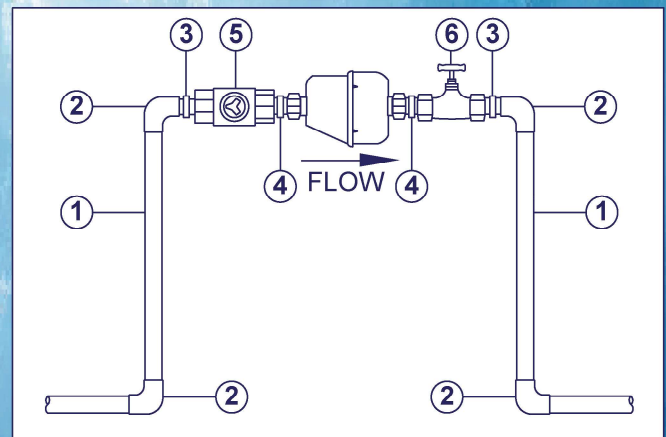

SPAN